

# the JACK

## Single Tenant Professional Services / Finance

22,432 RSF

267 RSF / PERSON

HEADCOUNT: 84

### WORK SPACES

69 Desks  
14 Focus Areas  
1 Boardroom



**JOE GOWAN**  
+1 206 607 1738  
joe.gowan@jll.com

**LLOYD LOW**  
+1 206 607 1796  
lloyd.low@jll.com

**CHARLIE HANAFIN**  
+1 415 395 4951  
charlie.hanafin@jll.com

All rights reserved. All information contained herein is from sources deemed reliable; however, no representation or warranty is made to the accuracy thereof. ©2023 Jones Lang LaSalle IP, Inc.

# URBAN VISIONS

Views of Downtown

Waterfront Park and  
Views of Elliott Bay

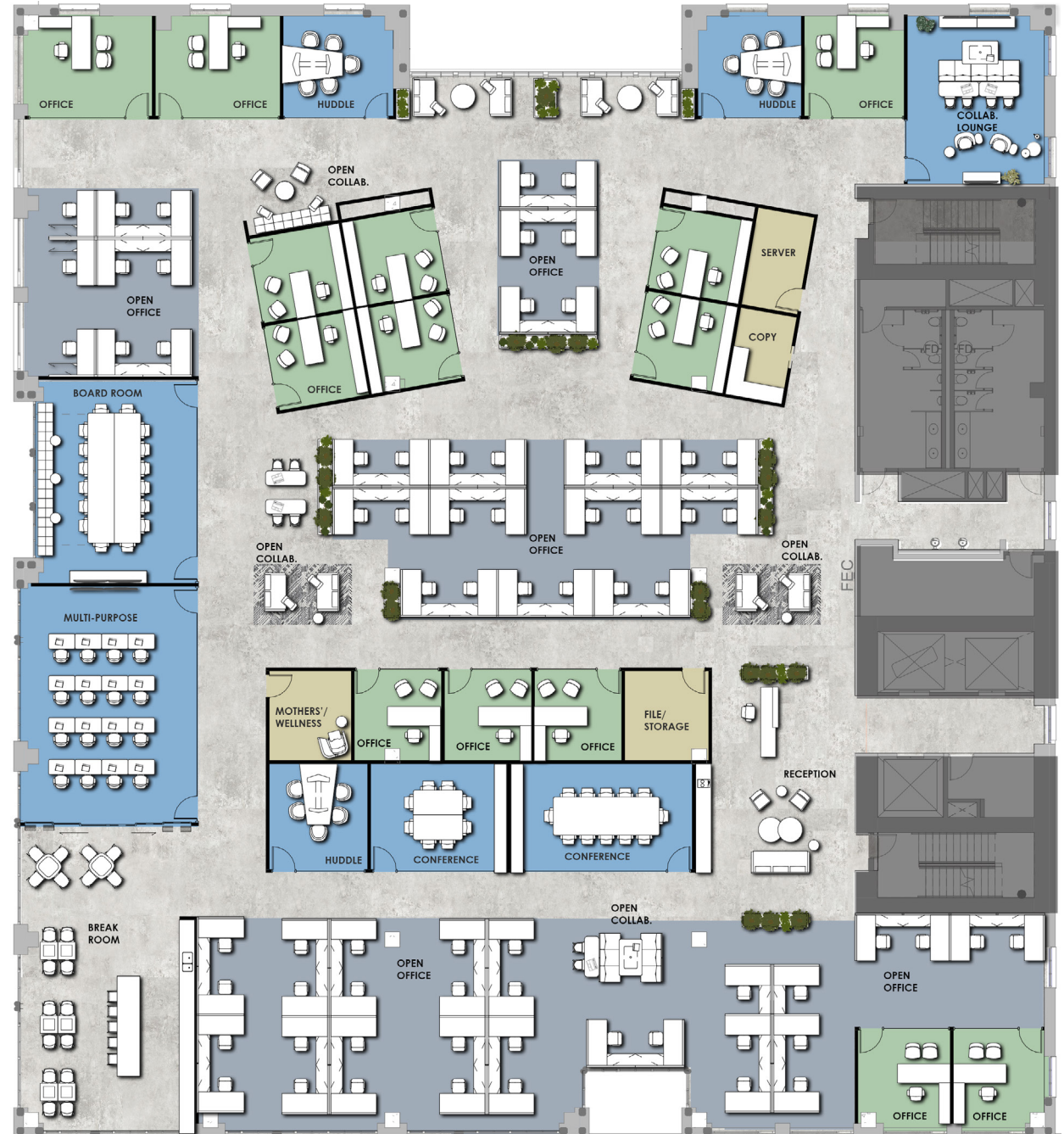

# the JACK

## Single Tenant Tech / Creative

22,460 RSF

170 RSF / PERSON

HEADCOUNT: 132

### WORK SPACES

130 Desks

5 Focus Areas

1 Private Offices



**JOE GOWAN**

+1 206 607 1738

joe.gowan@jll.com

**LLOYD LOW**

+1 206 607 1796

lloyd.low@jll.com

**CHARLIE HANAFIN**

+1 415 395 4951

charlie.hanafin@jll.com

All rights reserved. All information contained herein is from sources deemed reliable; however, no representation or warranty is made to the accuracy thereof. ©2023 Jones Lang LaSalle IP, Inc.

# URBAN VISIONS

Views of Downtown

Waterfront Park and  
Views of Elliott Bay





# the JACK

## Two Floor Tenant

Creative / Open

44,810 RSF

180 RSF / PERSON

HEADCOUNT: 249

### WORK SPACES

238 Desks

6 Hoteling Work Pods

4 Private Offices



**JOE GOWAN**  
+1 206 607 1738  
joe.gowan@jll.com

**LLOYD LOW**  
+1 206 607 1796  
lloyd.low@jll.com

**CHARLIE HANAFIN**  
+1 415 395 4951  
charlie.hanafin@jll.com

All rights reserved. All information contained herein is from sources deemed reliable; however, no representation or warranty is made to the accuracy thereof. ©2023 Jones Lang LaSalle IP, Inc.



Waterfront Park and  
Views of Elliott Bay

URBAN  
VISIONS

Views of Downtown



# the JACK

## Multi - Tenant

### Suite A:

#### Professional Services

9,679 RSF

254 RSF / PERSON

HEADCOUNT: 38

#### WORK SPACES

28 Workstations

9 Private Offices

### Suite B: Tech/Creative

11,064 RSF

187 RSF / PERSON

HEADCOUNT: 59

#### WORK SPACES

56 Workstations

2 Private Offices



JOE GOWAN

+1 206 607 1738

joe.gowan@jll.com

LLOYD LOW

+1 206 607 1796

lloyd.low@jll.com

CHARLIE HANAFIN

+1 415 395 4951

charlie.hanafin@jll.com

All rights reserved. All information contained herein is from sources deemed reliable; however, no representation or warranty is made to the accuracy thereof. ©2023 Jones Lang LaSalle IP, Inc.

URBAN  
VISIONS

Views of Downtown

Waterfront Park and  
Views of Elliott Bay

